

Lilydale Fossil Hunt

Friday, August 21, 2009

Understand and experience this site in St. Paul from a solid scientific perspective, rather than an evolutionary theory perspective. Most of the time will be spent finding fossils but we will also look at the plants and birds and other exciting parts of God's wonderful creation. Each person will find fossils and be able to take some of them home. Most are smaller than a quarter, but some may be several inches to several feet long. We leave the large ones for others to observe also. It is common to find fossil bivalves, brachiopods, bryozoans, crinoids, and gastropods. Some may find horn corals or even a rare cephalopod or trilobite.

Friday, August 21, 2009 9:00 a.m. to 12:15 p.m. or 1:00-4:15 p.m. Please arrive about 10 minutes early to finalize registration.

Organize your group or family and **contact us now**. Space is limited and it will be on a first reply basis. Don & Jeri Slinger scvcia1@juno.com 651-430-0751.

We will go rain or shine, unless there is a real heavy rain. Bring rain gear.

You will need good hiking boots and it is suggested that all wear pants due to the rugged terrain. Also bring sunscreen, drinking water, 5x hand lens or 5x magnifying lens, notebook and Ziplock bags. Optional items include screwdriver, fossil identification book, compass and camera. There is no drinking water or bathrooms within several miles. There is poison ivy along the trail.

Difficulty: We will walk about 1 ½ miles and experience about 300 feet of steep elevation change during the 3 hours. The road up the hill has gullies in it, but in other places you will be walking on rocky, muddy and at times in 1-3" of water or on very steep slippery terrain. **THERE IS NO INSURANCE or liability coverage** so parents, please attend with your children. Each family must bring a signed waiver or they will not be allowed on this "by waiver and permit only" site.

Cost: \$15.00 per family. (Payment must be received by August 12. No refunds after August 12. (Don Slinger, PO Box 221, Lake Elmo, MN 55042) A parent is expected to attend with their child(ren). Children ages 5 and older do well at this site. This site is used by college geology classes as well. One 40 page handbook is given to each family.

You will need a hand lens as most fossils are the size of a quarter or smaller. Bring your own hand lens of at least 5X. A 5X/10X hand lens will be for sale at the site for \$4.50 (tax included) if you do not have a hand lens.

Directions: Lilydale is in St. Paul on the south shore of the Mississippi River under and west of the High Bridge. Go south of I-35E and I-94 on Hwy. 52. Take the Plato exit – first exit south of the Lafayette Bridge. Go west on Plato until it T's and go left on Dr. Justus Ohage road (May be named Water street on older maps). Continue until you come to a falling down railroad trestle on your right. You will see the Lilydale Park sign on your left. If you go to far you will go under a railroad trestle. Enter the parking lot. If you are coming from the south: from the intersection of Hwy 13 and Lilydale road go about 2 ½ miles east. It is about 1/3 mile after you go under a railroad trestle. Lock your vehicle and have no valuables inside in sight. We will start at the parking lot.

An instructor will be present at the site to explain various aspects of it. Please ensure that each participant has a completed and signed waiver with them and that it is turned in at the beginning of the presentation. Failing to turn in a properly completed and signed waiver will automatically prevent the student or adult from participating in this program. Participants are there at their own risk. **No insurance or liability is provided.**

Participant Waiver

I understand and agree that I am participating in the above program voluntarily and at my own risk. I agree to indemnify and hold harmless the landowner, organizers, permit grantors and instructors from all claims of whatever kind or nature and for any negligence or other fault (not including intentional acts) that results in personal injury, death, or property damage during or in connection with the above program. The undersigned, for myself and for my heirs, executors, administrators and assignees, hereby releases and forever discharges the landowner, organizers, permit grantors and instructors from all such claims. This waiver will be construed according to the law of the State of Minnesota. The landowner, organizers, permit grantors and instructors fully acknowledges that some of the conditions and locations are hazardous to persons or property and that the individual participating in the program specifically assumes the liability as such claims or injuries may arise to persons or property due to its unsafe conditions.

Medical Release

I, the undersigned, hereby give my permission for the instructors to procure all necessary medical help for myself, my child or ward while said person is under the direct supervision of the instructors, and grant permission to their representatives to authorize any competent medical person to do all things reasonably necessary to take care of any injury or sickness. There is no health insurance or medical coverage provided. The signing of this form acknowledges that the participant/guardian accepts responsibility for payment of any medical treatment which may be required while they are in this program. I agree to the above participant waiver and medical release.

Participant's Name(s): _____

Date: _____

Parent or Legal Guardian Signature: _____

Date: _____

Emergency Contact

Name: _____

Relationship: _____

Address: _____

City: _____ State: _____ Zip: _____

Day Phone: _____ Evening Phone: _____

Parents must accompany their children.

Remember there is NO Insurance. You are totally liable. You are there at your own risk.

Lilydale Regional Park Access Routes

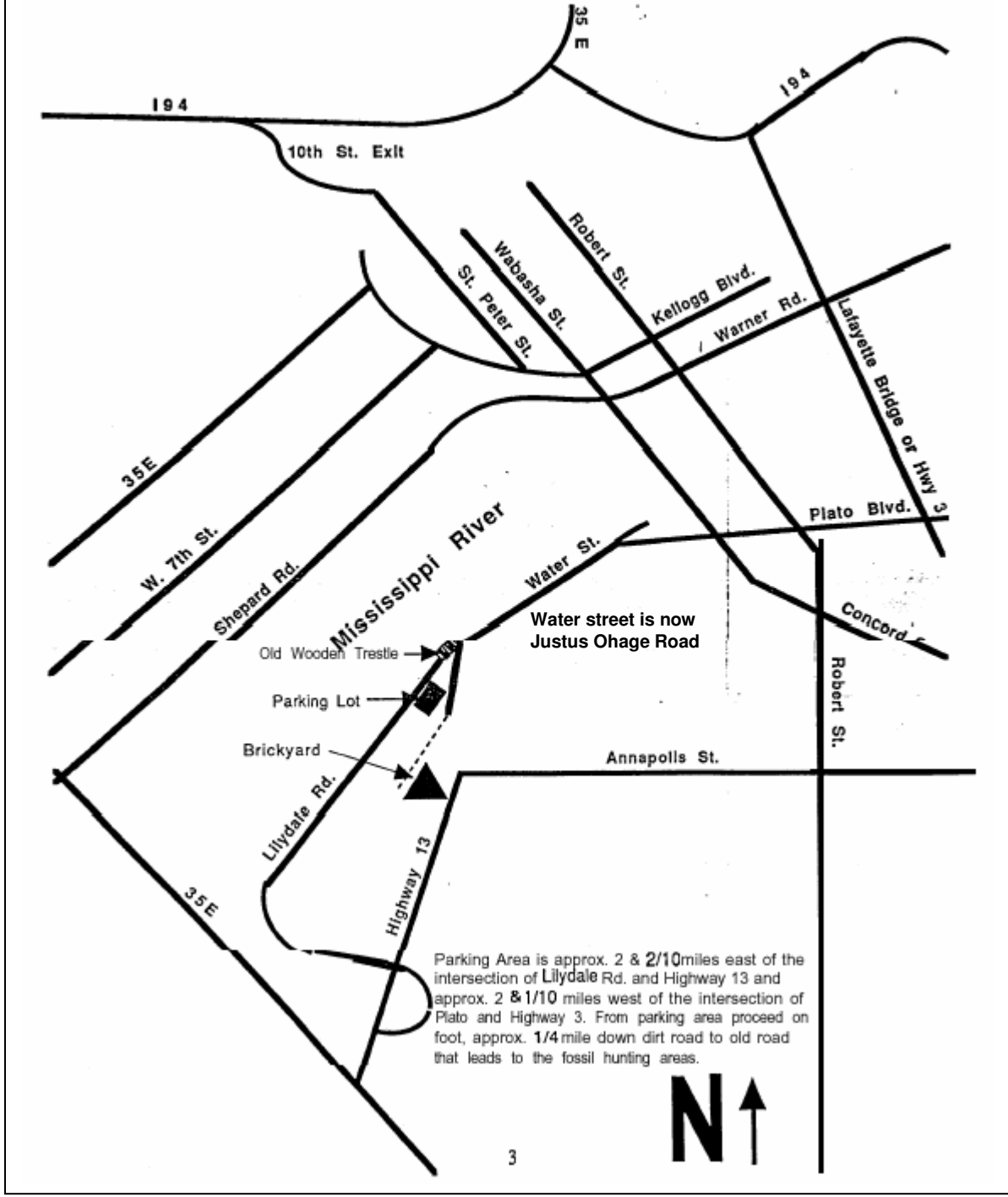

Parking Area is approx. 2 & 2/10 miles east of the intersection of Lilydale Rd. and Highway 13 and approx. 2 & 1/10 miles west of the intersection of Plato and Highway 3. From parking area proceed on foot, approx. 1/4 mile down dirt road to old road that leads to the fossil hunting areas.

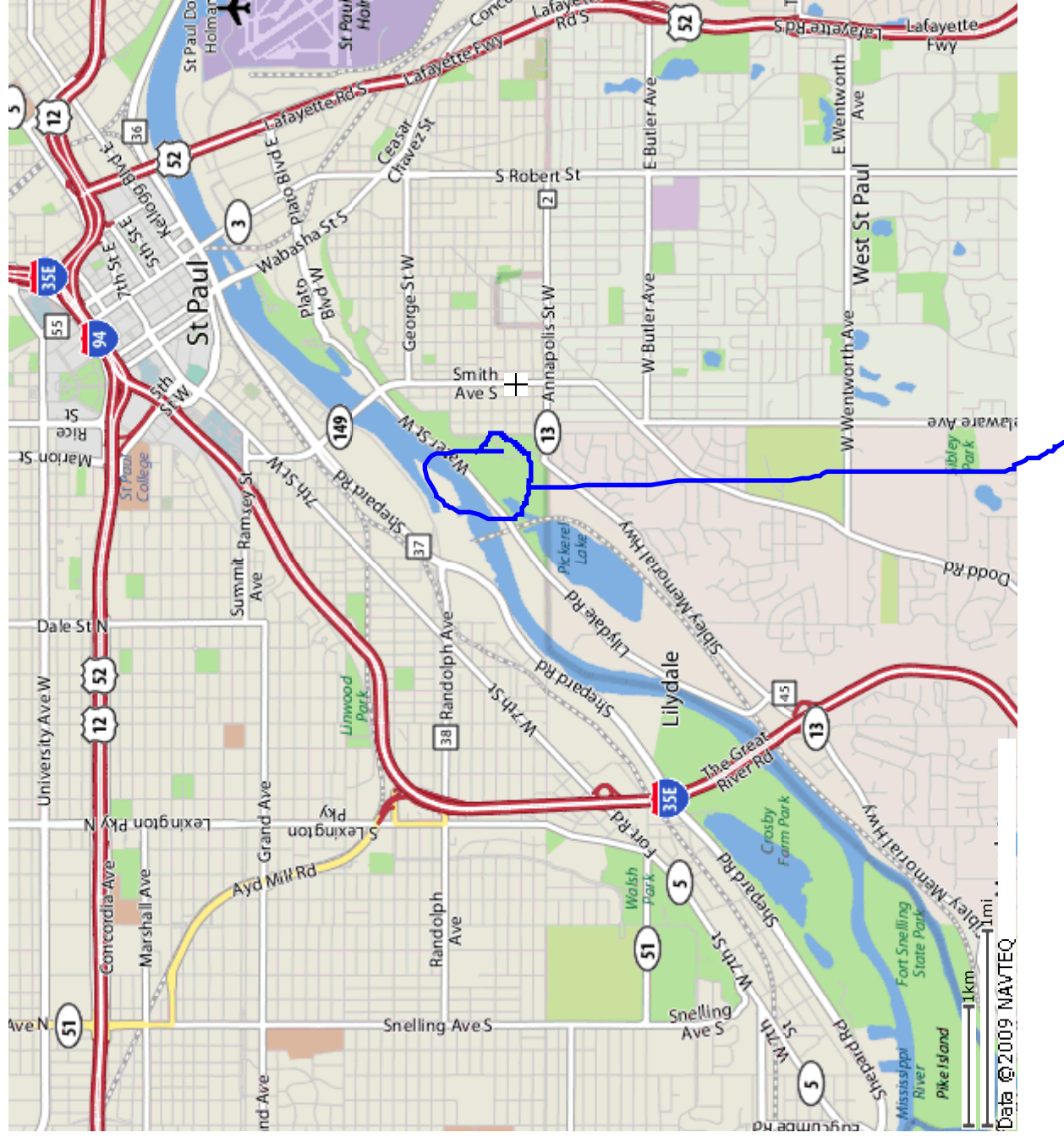

Data © 2009 NAVTEQ